

Assembled Stations & enclosures

ABB Assembled stations & enclosures



8

Features

- Available for 1, 2, 3, 4 & 6 operators.
- Base mounted contacts allow for easy removal of operator cover. Wiring remains with base.
- Up to 5 contact blocks can be used per operator for some combinations.
- Environmental ratings: UL/CSA Type 1, 3R, 4, 4X, 12 & 13, IP66
- Available in high impact strength polycarbonate (plastic) material.
- Rated for outdoor use.
- Enclosures can withstand light acid solutions and other chemicals.
- Metallic NEMA 4X & 12 stainless steel enclosures available.

Plastic enclosures, empty Modular range, 22mm

Empty plastic enclosures Now with stainless steel screws

Size	Color top/bottom	Catalog No.	Ref. Code	List Price
1-seat	Dark grey/Light grey	MEP1-0	1SFA 611 811 R1000	\$ 28.00
1-seat	Yellow/Light grey	MEPY1-0	1SFA 611 821 R1000	28.00
2-seat	Dark grey/Light grey	MEP2-0	1SFA 611 812 R1000	32.00
3-seat	Dark grey/Light grey	MEP3-0	1SFA 611 813 R1000	36.00
4-seat	Dark grey/Light grey	MEP4-0	1SFA 611 814 R1000	44.00
6-seat	Dark grey/Light grey	MEP6-0	1SFA 611 816 R1000	52.00

When Ordering

- Select operators from page 8.4 and 8.38.
N.B. Selector switches with short handle for vertically mounted selector switches must be Ref.ed from page 8.45 - 8.46
- Select contact blocks and lamp blocks for rear mounting, see page 8.45
- Accessories, see page 8.45
N.B. **One spacer per operator** has to be Ref.ed if legend plate is not used.
(for rear mounted pilot devices)

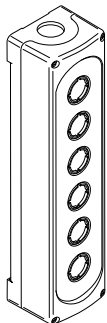
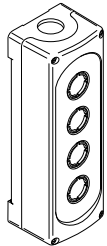
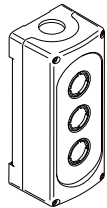
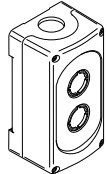
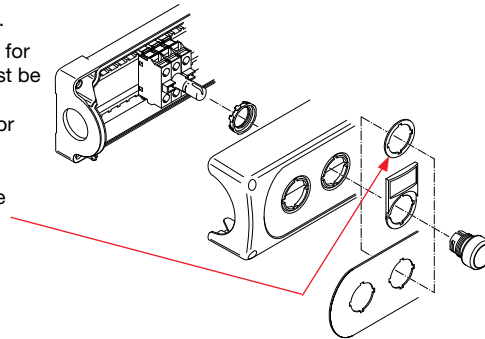

Plastic enclosures, assembled stations 1, 2 & 3 seat, 22mm Modular range

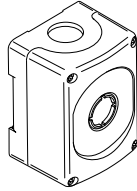

1 Position

1-seat Plastic enclosures. Yellow top/light grey bottom

Description					Catalog No.	List Price
	Pos - 1	Pos - 2	Pos - 3	Pos - 4		
Type	Twist Release 40mm E	—	—	—	P1-ES	\$ 84.00
Color	Stop	—	—	—		
Contacts	Red	—	—	—		
Name plate	2 NC	—	—	—		
	EMERGENCY STOP	—	—	—		
Type	III. Twist Release 40mm E	—	—	—	P1-1ES	107.50
Color	40mm E-Stop	—	—	—		
Contacts	Red, 120V filament	—	—	—		
Name plate	2 NC, 1 LB	—	—	—		
	EMERGENCY STOP	—	—	—		

1-seat Plastic enclosure, dark grey top/light grey bottom

Description					Catalog No.	List Price
	Pos - 1	Pos - 2	Pos - 3	Pos - 4		
Type	3-pos sel. Main	—	—	—	P1-HOA	\$ 55.00
Color	Black	—	—	—		
Contacts	2 NO	—	—	—		
Name plate	HAND/OFF/AUTO	—	—	—		
	—	—	—	—		

2-seat Plastic enclosure, dark grey top/light grey bottom

Description					Catalog No.	List Price
	Pos - 1	Pos - 2	Pos - 3	Pos - 4		
Type	Button mom, Ext.	Button mom, Flush	—	—	P2-SS	\$ 63.20
Color	Red	Green	—	—		
Contacts	1 NC	1 NO	—	—		
Name plate	STOP	START	—	—		
	—	—	—	—		
Type	3-pos sel. Main	Pilot Light	—	—	P2-1HOARL	90.00
Color	Black	Red	—	—		
Contacts	2 NO	1 LB, 120V filament	—	—		
Name plate	HAND/OFF/AUTO	RUN	—	—		
	—	—	—	—		
Type	2-pos sel. Main	Pilot Light	—	—	P2-100RL	82.00
Color	Black	Red	—	—		
Contacts	1 NO	1 LB, 120V filament	—	—		
Name plate	ON/OFF	RUN	—	—		
	—	—	—	—		

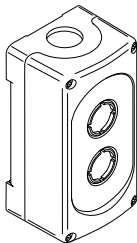

2 Position

1 Position

3-seat Plastic enclosure, dark grey top/light grey bottom

Description					Catalog No.	List Price
	Pos - 1	Pos - 2	Pos - 3	Pos - 4		
Type	Button mom, Ext.	Button mom, Flush	Pilot Light	—	P3-1SSRL	\$ 96.70
Color	Red	Green	Red	—		
Contacts	1 NC	1 NO	1 LB, 120V filament	—		
Name plate	STOP	START	RUN	—		
	—	—	—	—		
Type	3-pos sel. Main	Pilot Light	Pilot Light	—	P3-1HOARLGL	123.50
Color	Black	Red	Green	—		
Contacts	2 NO	1 LB, 120V filament	1 LB, 120V filament	—		
Name plate	HAND/OFF/AUTO	RUN	OFF	—		
	—	—	—	—		
Type	2-pos sel. Main	Pilot Light	Pilot Light	—	P3-100RLGL	115.50
Color	Black	Red	Green	—		
Contacts	1 NO	1 LB, 120V filament	1 LB, 120V filament	—		
Name plate	ON/OFF	RUN	OFF	—		
	—	—	—	—		
Type	3-pos sel. Main	Button mom, Flush	Pilot Light	—	P3-1HOASRL	109.60
Color	Black	Green	Red	—		
Contacts	2 NO	1 NO	1 LB, 120V filament	—		
Name plate	HAND/OFF/AUTO	START	RUN	—		
	—	—	—	—		
Type	Twist Release 40mm E Stop	3-pos sel. Main	Pilot Light	—	P3-1ESHOARL	145.50
Color	Red	Black	Red	—		
Contacts	2 NC	2 NO	1 LB, 120V filament	—		
Name plate	EMERGENCY STOP	HAND/OFF/AUTO	RUN	—		
	—	—	—	—		
Type	5kOhm Pot	Stop	Start	—	MEP3-SSPOT5	140.00
Color	Black	Red	Green	—		
Contacts	Leads	1NO+1NC	1NO+1NC	—		
Name Plate	Scale	(text cap)	(text cap)	—		
	—	—	—	—		

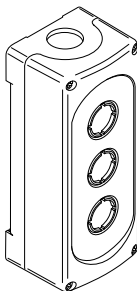

3 Position

2 Position

1 Position

Plastic enclosures, assembled stations

4 seat Modular range

4-seat Plastic enclosure, dark grey top/light grey bottom

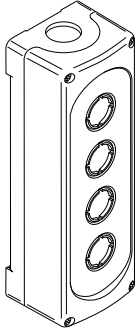

← 4 Position
← 3 Position
← 2 Position
← 1 Position

Description					Catalog No.	List Price
	Pos - 1	Pos - 2	Pos - 3	Pos - 4		
Type	Button mom., Ext.	Button mom., Flush	Pilot Light Green	Pilot Light Red	P4-1SSRLGL	\$ 134.20
Color	Red	Green				
Contacts	1 NC	1 NO	1 LB, 120V filament	1 LB, 120V filament		
Name plate	STOP	START	OFF	RUN		
Type	3-pos sel. Main	Button mom, Flush	Pilot Light Green	Pilot Light RED	P4-1HOASRLGL	147.10
Color	Black	Green				
Contacts	2 NO	1 NO	1 LB, 120V filament	1 LB, 120V filament		
Name plate	HAND/OFF/AUTO	START	OFF	RUN		
Type	3-pos sel. Main	Pilot Light Green	Pilot Light Yellow	Pilot Light Red	P4-1HOARLYLGL	161.00
Color	Black					
Contacts	2 NO	1 LB, 120V filament	1 LB, 120V filament	1 LB, 120V filament		
Name plate	HAND/OFF/AUTO	OFF	FAULT	RUN		
Type	2-pos. sel. Main	Pilot Light Green	Pilot Light Yellow	Pilot Light Red	P4-1OORLYLGL	153.00
Color	Black					
Contacts	1 NO	1 LB, 120V filament	1 LB, 120V filament	1 LB, 120V filament		
Name plate	ON/OFF	OFF	FAULT	RUN		
Type	Twist Release 40mm E Stop	Button mom., Ext.	Button mom., Flush	Pilot Light Red	P4-1ESSRL	156.20
Color	Red	Red	Green			
Contacts	2 NC	1 NC	1 NO	1 LB, 120V filament		
Name plate	EMERGENCY STOP	STOP	START	RUN		
Type	Twist Release 40mm E Stop	3-pos. sel. Main	Pilot Light Green	Pilot Light Red	P4-1ESHOARLGL	183.00
Color	Red	Black				
Contacts	2 NC	2 NO	1 LB, 120V filament	1 LB, 120V filament		
Name plate	EMERGENCY STOP	HAND/OFF/AUTO	OFF	RUN		
Type	Twist Release 40mm E Stop	2-pos sel. Main	Pilot Light Green	Pilot Light Red	P4-1ESOORLGL	175.00
Color	Red	Black				
Contacts	2 NC	1 NO	1 LB, 120V filament	1 LB, 120V filament		
Name plate	EMERGENCY STOP	ON/OFF	OFF	RUN		

Accessories Modular range

Pilot Devices
Stations &
Enclosures

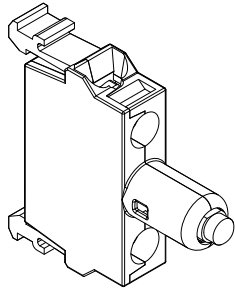

Lamp blocks with integrated LEDs — for base mounting into enclosures

Description	Catalog No.	Ref. Code	List Price	
12V DC rated voltage				
Red	MLBL-00BR	1SFA611621R2001	\$ 25.50	
Green	MLBL-00BG	1SFA611621R2002		
Yellow	MLBL-00BY	1SFA611621R2003		
Blue	MLBL-00BL	1SFA611621R2004		
White	MLBL-00BW	1SFA611621R2005		
24V AC/DC rated voltage				
Red	MLBL-01BR	1SFA611621R2011		
Green	MLBL-01BG	1SFA611621R2012		
Yellow	MLBL-01BY	1SFA611621R2013		
Blue	MLBL-01BL	1SFA611621R2014		
White	MLBL-01BW	1SFA611621R2015		
48V AC/DC rated voltage				
Red	MLBL-02BR	1SFA611621R2021		
Green	MLBL-02BG	1SFA611621R2022		
Yellow	MLBL-02BY	1SFA611621R2023		
Blue	MLBL-02BL	1SFA611621R2024		
White	MLBL-02BW	1SFA611621R2025		
110-130V AC rated voltage				
Red	MLBL-04BR	1SFA611621R2041		
Green	MLBL-04BG	1SFA611621R2042		
Yellow	MLBL-04BY	1SFA611621R2043		
Blue	MLBL-04BL	1SFA611621R2044		
White	MLBL-04BW	1SFA611621R2045		
110-130V DC rated voltage				
Red	MLBL-05BR	1SFA611621R2051		
Green	MLBL-05BG	1SFA611621R2052		
Yellow	MLBL-05BY	1SFA611621R2053		
Blue	MLBL-05BL	1SFA611621R2054		
White	MLBL-05BW	1SFA611621R2055		
220V DC rated voltage				
Red	MLBL-06BR	1SFA611621R2061		
Green	MLBL-06BG	1SFA611621R2062		
Yellow	MLBL-06BY	1SFA611621R2063		
Blue	MLBL-06BL	1SFA611621R2064		
White	MLBL-06BW	1SFA611621R2065		
230V DC rated voltage				
Red	MLBL-07BR	1SFA611621R2071		
Green	MLBL-07BG	1SFA611621R2072		
Yellow	MLBL-07BY	1SFA611621R2073		
Blue	MLBL-07BL	1SFA611621R2074		
White	MLBL-07BW	1SFA611621R2075		

8

Accessories Modular range

8

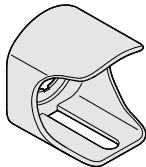
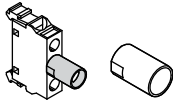
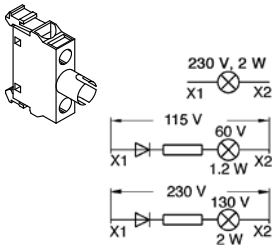
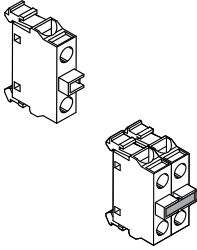

Yellow shroud

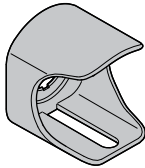

Gray shroud

Contact blocks for rear mounting

Description	Catalog No.	Ref. Code	List Price
Contact blocks			
1NO	MCB-10B	1SFA 611 610 R2001	\$ 8.00
1NC	MCB-01B	1SFA 611 610 R2010	
Double contact block			
2NO	MCB-20B	1SFA 611 610 R2002	16.00
2NC	MCB-02B	1SFA 611 610 R2020	
1NO+1NC	MCB-11B	1SFA 611 610 R2011	
Contact blocks with gold plated contacts			
1NO	MCB-10BG	1SFA 611 610 R2101	16.00
1NC	MCB-01BG	1SFA 611 610 R2110	
Lamp blocks			
For max. 2 W, 230 V AC and DC filament bulb or LED	MLB-1B	1SFA 611 620 R2001	17.50
115 V AC supply voltage.			
For 60 V filament bulb max. 1.2 W	MLB-2B	1SFA 611 620 R2002	21.50
230 V AC supply voltage.			
For 130 V filament bulb max. 2 W	MLB-3B	1SFA 611 620 R2003	21.50
Protective sleeve			
Description	Catalog No.	Ref. Code	List Price
To make a rear mounted lamp block screen protected. IP20	5396 0543-1	5396 0543-1	\$ 1.50
Earthing terminal			
Description	Catalog No.	Ref. Code	List Price
For plastic enclosure.	MA5-3005	1SFA 611 925 R3005	\$ 2.00
Shrouds			
Description	Catalog No.	Ref. Code	List Price
Yellow	MA1-8053	1SFA611920R8053	\$ 12.00
Gray	MA1-8128	1SFA611920R8128	

Accessories

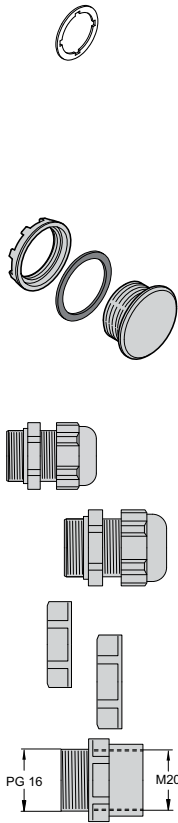

Spacer

Description	Catalog No.	Ref. Code	List Price
1 mm thick. Needed when legend plates are not used in plastic enclosures. Spacer (Packing unit 10 pieces)	SK 615 516-1	SK 615 516-1	\$ 1.00
Spacer for Modular emergency stop pushbutton (Packing unit 10 pieces)	KA1-8045	1SFA 616 920 R 8045	1.00

Blanking plug

Description	Catalog No.	Ref. Code	List Price
Grey plastic, 22mm	MA1-8129	1SFA 611 920 R8129	\$ 5.80
Black plastic, 22mm	MA1-8130	1SFA 611 920 R8130	5.80
Black plastic, 30mm	MA1-8133	1SFA 611 920 R8133	7.30

Cable gland

Description	Catalog No.	Ref. Code	List Price
PG 13.5	MA5-3006	1SFA 611 925 R3006	\$ 8.40
PG 16	MA5-3007	1SFA 611 925 R3007	9.40

Nut

Description	Catalog No.	Ref. Code	List Price
PG 13.5	MA5-3008	1SFA 611 925 R3007	\$ 2.60
PG 16	MA5-3009	1SFA 611 925 R3009	2.60

Adaptor

Description	Catalog No.	Ref. Code	List Price
PG 16/M20	MA5-3010	1SFA 611 925 R3010	\$ 16.20