

OVS OVRP

Residential Wall Fan Heater

Residential Ceiling Fan Heater

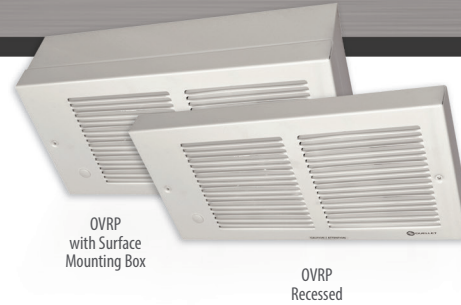

Features

Color

- Standard: white, almond.
- Optional (upcharge applicable): metallic silver, bronze, metallic charcoal, aluminum, semi-gloss black, sand.
- Custom colors available upon request.

Finish

- Standard: epoxy/polyester powder paint.

Construction

- 20-gauge steel cabinet.
- 22-gauge steel front cover.
- High-limit temperature control with automatic reset.

Fan

- Quiet fan operating.
- 120V, 208V, 240/208V models: 500W to 1000W; 40 cfm fan and 1250W to 2000W; 80 cfm fan.
- 347V models : 80 cfm fan.
- Factory-lubricated motor.

Heating element

- 120V, 208V, 208/240V: durable tubular heating element with fins.
- Factory sealed element available.
- 347V: Iron-Chromium-Aluminum alloy.

Control

- If an electronic thermostat is used, it must be compatible with forced-air heaters.

Installation

- Quick installation with recess box mounting holes.
- Large wiring compartment.
- Surface mounting box available.
- Tight fit with V-shaped recess box.

Warranty

- 5-year warranty against defects.

Application

- Entrance way, kitchen, bathroom, family room, basement.

OVS Features

Voltage

- 120V, 208V, 240/208V, 347V, 1-phase.

Control

- Built-in thermostat available with a control knob or tamperproof.

Installation

- Wall installation only.
- The air outlet should be installed at least 10 in. (25.4 cm) above floor.
- May be recessed in 2 in. X 3 in. stud partitions.

OVRP Features

Voltage

- 120V, 240/208V, 347V, 1-phase.

Control

- Must be used with a compatible wall thermostat (not included).

Installation

- Ceiling installation only.
- The air outlet should be installed at least 10 in. (25.4 cm) from the wall.
- May be recessed in ceiling.

Mounting positions available. Pictures showing front panel. Directional vane air flow.

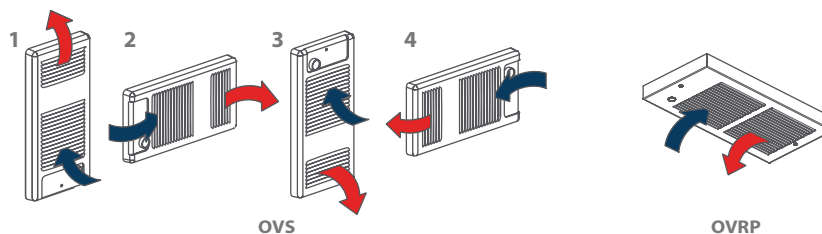

OVS Models

Watts	Watts 240/208V	Product #						Weight		
		120V	Price	208V	240/208V	Price	347V	Price	lb	kg
500	500/375	OVS0502	190.00	-	OVS0500	186.00	-	-	9.0	4.1
750	750/563	OVS0752	190.00	-	OVS0750	186.00	-	-	9.0	4.1
1000	1000/750	OVS1002	202.00	-	OVS1000	197.00	OVS1007	245.00	9.0	4.1
1250	1250/938	OVS1252	220.00	-	OVS1250	197.00	-	-	9.0	4.1
1500	1500/1125	OVS1502	220.00	-	OVS1500	217.00	OVS1507	259.00	9.0	4.1
2000	2000/1500	-	-	OVS2008	OVS2000	240.00	OVS2007	272.00	9.0	4.1

OVS Options

Product #	Price	Description	Factory Installed	Kit
OVS-BS	45.00	Surface mounting box	-	✓
OVS-DIS ¹	110.00	Disconnect switch, 20A at 277V max. (120V, 208V, 240/208V only)	✓	✓
OVS-ES ²	21.00	Factory sealed element (120V, 208V, 240/208V only)	✓	-
OVS-TB6	40.00	Single-pole bi-metal thermostat (347V factory installed only)	✓	✓
OVS-TB26 ³	49.00	Double-pole bi-metal thermostat (347V factory installed only)	✓	✓
OVS-TB6-AV	46.00	Single-pole bi-metal tamperproof thermostat (347V factory installed only)	✓	✓
OVS-TB26-AV ³	49.00	Double-pole bi-metal tamperproof thermostat (347V factory installed only)	✓	✓

OVRP Models

Watts	Watts 240/208V	Product #						Weight	
		120V	Price	240/208V	Price	347V	Price	lb	kg
500	500/375	OVRP0502	220.00	OVRP0500	214.00	-	-	9.0	4.1
750	750/563	OVRP0752	220.00	OVRP0750	214.00	-	-	9.0	4.1
1000	1000/750	OVRP1002	234.00	OVRP1000	226.00	OVRP1007	346.00	9.0	4.1
1250	1250/938	OVRP1252	257.00	OVRP1250	226.00	-	-	9.0	4.1
1500	1500/1125	OVRP1502	257.00	OVRP1500	250.00	OVRP1507	371.00	9.0	4.1
2000	2000/1500	-	-	-	-	OVRP2007	410.00	9.0	4.1

OVRP Options

Product #	Price	Description	Factory Installed	Kit
OVR-BS	45.00	Surface mounting box	-	✓
OVR-DIS ¹	110.00	Disconnect switch, 20A at 277V max. (120V, 208V, 240/208V only)	✓	✓
OVR-ES ²	21.00	Factory sealed element (120V, 208V, 240/208V only)	✓	-

¹For the U.S. only: The nominal current of the unit must not exceed 80% of the capacity of the disconnect.

²The option "sealed element" increases the reliability of these in humid environments. It does not completely eliminate the leakage currents of metal sheathed heating elements.

³Off position.

Add "BL" for white, "AM" for almond.

Upcharge applicable for optional colors shown in the color chart section.

For options available as factory installed and kit, if not mentioned on the order, will automatically be shipped as a kit.

