

Heavy-Duty Ring Terminals

Strong enough for tough applications!

Nylon & Vinyl #16-14 AWG — Heavy Duty



Sta-Kon Terminal Products and Tools

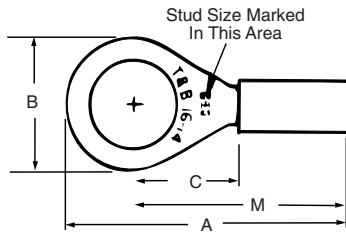

Nylon or Vinyl Insulated

..... Specifications

Material — Copper .050 thick

Finish — Electro tin-plate

Wire Range — #16-14

Color Code — Green vinyl or nylon insulator

Most standard bulk catalog numbers can be put on Mylar Tape for reel-fed applications (i.e., 12050 tool and application dies). See pages C?? - C??.

Please put the suffix "M" for Mylar Tape RA2573M.

(Bulk number 1,000 and 500 packages.)

CAT. NO.	PKG. QTY.	WIRE RANGE	MAX. INS.	BOLT HOLE	WT./LBS. PER 1,000	DIMENSIONS			
						A	B	C	M
RBC14-6	50	16-14 Heavy Duty	.210	#6		.98	.25	.29	.85
RBC853	500	Use RC Tooling	.210	#6		.98	.25	.29	.85
RBC14-8	50	16-14 Heavy Duty	.210	#8		1.04	.39	.29	.85
RBC863	500	Use RC Tooling	.210	#8		1.04	.39	.29	.85
RBC14-10	50	16-14 Heavy Duty	.210	#10		1.04	.39	.29	.85
RBC873	500	Use RC Tooling	.210	#10		1.04	.39	.29	.85
RBC14-14	50	16-14 Heavy Duty	.210	1/4"		1.10	.51	.29	.85
RBC713	500	Use RC Tooling	.210	1/4"		1.10	.51	.29	.85
RBC14-516	50	16-14 Heavy Duty	.210	5/16"		1.21	.54	.38	.94
RBC723	500	Use RC Tooling	.210	5/16"		1.21	.54	.38	.94
RBC14-38	50	16-14 Heavy Duty	.210	3/8"		1.26	.63	.38	.94
RBC793	500	Use RC Tooling	.210	3/8"		1.26	.63	.38	.94
RBC14-12	50	16-14 Heavy Duty	.210	1/2"		1.49	.76	.54	1.11
RBC753	500	Use RC Tooling	.210	1/2"		1.49	.76	.54	1.11
14RBC-6	50	16-14 Heavy Duty	.210	#6	5	1.06	.25	.29	.93
RBC857	500	Use RC Tooling	.210	#6	5	1.06	.25	.29	.93
14RBC-8	50	16-14 Heavy Duty	.210	#8	5	1.13	.39	.29	.93
RBC867	500	Use RC Tooling	.210	#8	5	1.13	.39	.29	.93
14RBC-10	50	16-14 Heavy Duty	.210	#10	5	1.13	.39	.29	.93
RBC877	500	Use RC Tooling	.210	#10	5	1.13	.39	.29	.93
14RBC-14	50	16-14 Heavy Duty	.210	1/4"	6	1.19	.51	.29	.93
RBC717	500	Use RC Tooling	.210	1/4"	6	1.19	.51	.29	.93
14RBC-516	50	16-14 Heavy Duty	.210	5/16"	6	1.29	.54	.38	1.03
RBC727	500	Use RC Tooling	.210	5/16"	6	1.29	.54	.38	1.03
14RBC-38	50	16-14 Heavy Duty	.210	3/8"	6	1.34	.63	.38	1.03
RBC797	500	Use RC Tooling	.210	3/8"	6	1.34	.63	.38	1.03
14RBC-12	50	16-14 Heavy Duty	.210	1/2"	6	1.57	.76	.54	1.19
RB757	500	Use RC Tooling	.210	1/2"	6	1.57	.76	.54	1.19

WT2000, WT145C, and power tools as recommended crimp in the 12-10 nest (yellow).

The heavy-duty terminal solution!

Non-Insulated #16-14 AWG — Heavy Duty

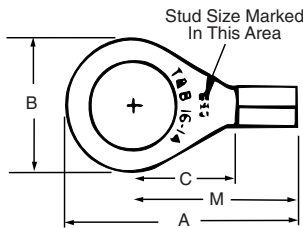

Non-Insulated

CAT. NO.	PKG. QTY.	WIRE RANGE	MAX. INS.	BOLT HOLE	WT./LBS. PER 1,000	DIMENSIONS			
						A	B	C	M
BC14-6	50	16-14 Heavy Duty	—	#6		.81	.25	.29	.68
BC85	500	Use RC Tooling	—	#6		.81	.25	.29	.68
BC14-8	50	16-14 Heavy Duty	—	#8		.87	.39	.29	.68
BC86	500	Use RC Tooling	—	#8		.87	.39	.29	.68
BC14-10	50	16-14 Heavy Duty	—	#10		.87	.39	.29	.68
BC87	500	Use RC Tooling	—	#10		.87	.39	.29	.68
BC14-14	50	16-14 Heavy Duty	—	1/4"		.93	.51	.29	.68
BC71	500	Use RC Tooling	—	1/4"		.93	.51	.29	.68
BC14-516	50	16-14 Heavy Duty	—	5/16"		1.04	.54	.38	.77
BC72	500	Use RC Tooling	—	5/16"		1.04	.54	.38	.77
BC14-38	50	16-14 Heavy Duty	—	3/8"		1.09	.63	.38	.77
BC79	500	Use RC Tooling	—	3/8"		1.09	.63	.38	.77
BC14-12	50	16-14 Heavy Duty	—	1/2"		1.32	.76	.54	.94
BC75	500	Use RC Tooling	—	1/2"		1.32	.76	.54	.94

WT111M, WT2000, and power tools as recommended, crimp in the 12-10 nest.